

FORM No. 1.

Course & distances of the
Division line from the po
on the line of W^m Brown

PO	S	30	E	10.5	WO
	S	16	E	12	HickY
	S	58	E	16	WO
	S	38	E	13	M ^y berry
	N	60	E	14	Chest
	N	82	E	24.7	Walnut
	N	38	E	18	P.O.
	N	17	E	8.1	HickY

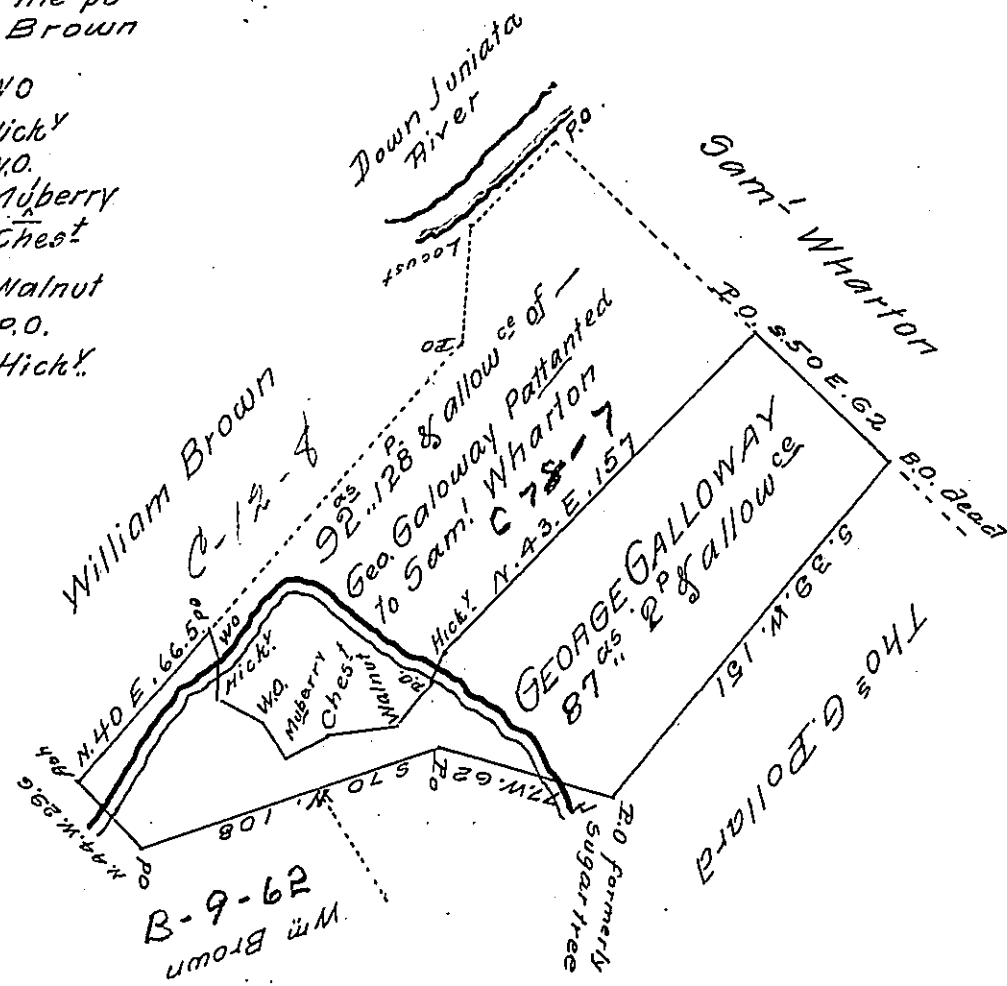

Draft of 87 acres & 2 perches of land & allow^{ce} situate in Shirley Town-
ship Cumberland, Bedford or Huntingdon County now Wayne Town-
ship Mifflin County. Being part 179 acres & 130 which was sur-
veyed on 13th Oct^r 1767 on a warrant granted to George Galloway dated
28th Feb^r 1766 & the above part resurveyed by Walter B. Hudson on the
19th March 1840 which I have examined this 6th August 1840 and
found correct

John Shaw D.S.

To Jacob Sallade Esq^r
Surveyor Gen^l of Penn^a

IN TESTIMONY that the above is a copy of the original remaining on file in
the Department of Internal Affairs of Pennsylvania, made
conformably to an Act of Assembly approved the 16th day of
February 1833, I have hereunto set my hand and caused
the Seal of said Department to be affixed at Harrisburg,
this thirty-first day of October 1907

Henry Howell
Secretary of Internal Affairs.